

Power Jacks

Features

- Panel Mount Types
- Metal Housing

Specifications

Rating: 30VDC, 5A (57-PJ10 thru 57-PJ40)
 24VDC, 2A (57-PJ50 thru 57-PJ80)
 30VDC, 2A (57-PJ90 Only)

Contact Resistance: $\leq 0.03\Omega$

Insulation Resistance: $\geq 100M\Omega$

Withstanding Voltage: 500VAC

Inserting and Extraction Force: 3 to 20N

Life Test: 5000 cycles

Temperature: -20° to $+85^{\circ}\text{C}$

Ordering Information

NTE Type No.	Description	Mounting Hole	Diag No.
57-PJ10	5.5mm x 2.1mm Jack	.437" (11.0)	JK-01
57-PJ20	5.5mm x 2.5mm Jack	.437" (11.0)	JK-01
57-PJ30	5.5mm x 2.1mm Jack	.313" (8.0)	JK-02
57-PJ40	5.5mm x 2.5mm Jack	.313" (8.0)	JK-02
<i>NEW</i> 57-PJ50	5.5mm x 2.1mm Jack	.320" (8.1)	JK-03
<i>NEW</i> 57-PJ60	5.5mm x 2.5mm Jack	.320" (8.1)	JK-03
<i>NEW</i> 57-PJ70	5.5mm x 2.1mm Jack	.320" (8.1)	JK-04
<i>NEW</i> 57-PJ80	5.5mm x 2.5mm Jack	.320" (8.1)	JK-04
<i>NEW</i> 57-PJ90	5.0mm x 2.1mm Jack	.350" (8.9) x .430" (10.9)	JK-05

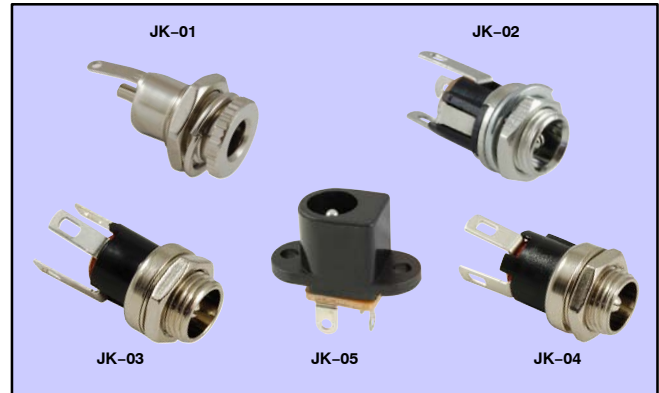

JK-01

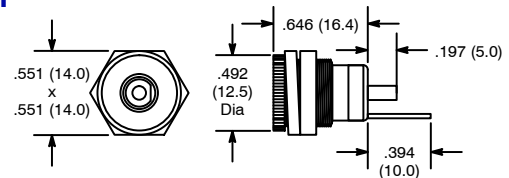

JK-02

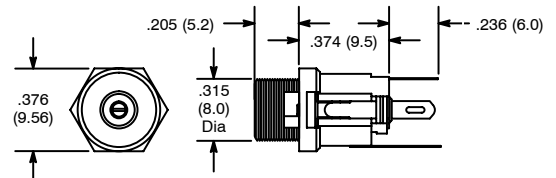

JK-03

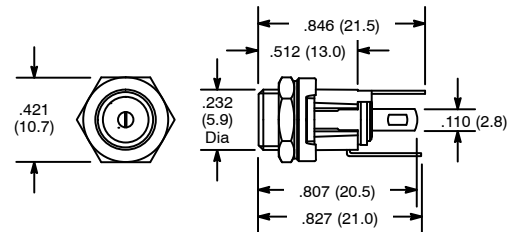

JK-04

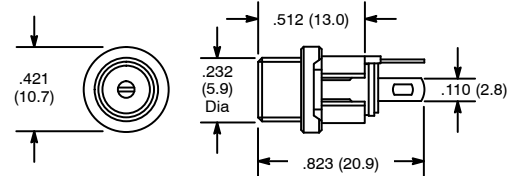

JK-05

