

1 2 3 4 5 6 7 8

F

F

E

E

D

D

C

C

B

B

A

A

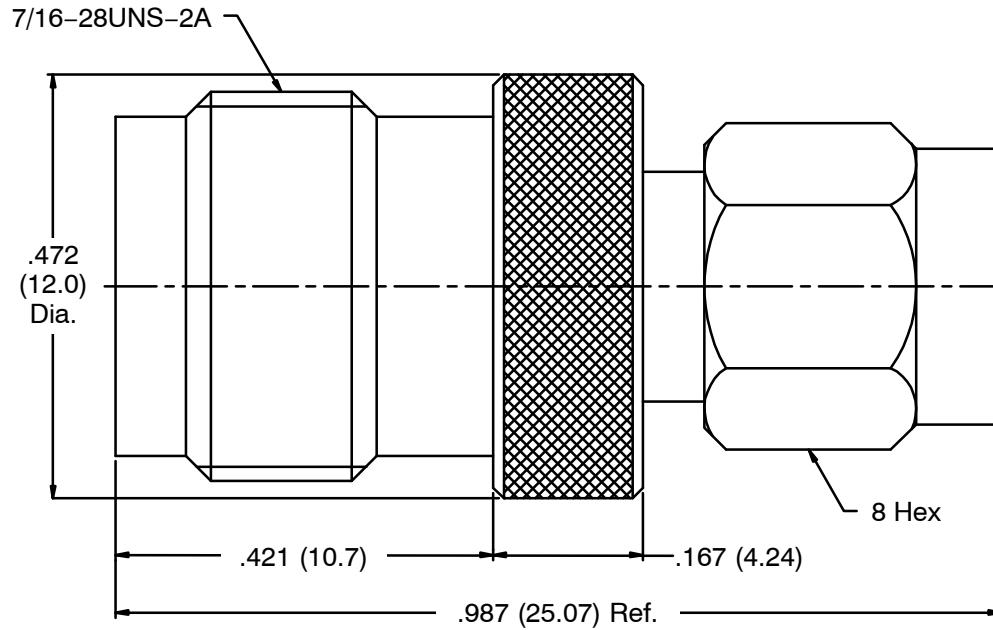

NOTES: Finish (Plating Thickness in Micro-inches)
 1. Brass
 2. Nickel Pl. 100 Min. Thick over Copper Pl. 50 Min. Thick
 3. Phosphor Bronze
 4. Gold Pl. 3 Min Thick over Nickel Pl. 50 Min. Thick over Copper Pl. 50 Min. Thick
 5. Teflon

RoHS Compliant

| | | | | | | | | | |
|---|-------------|----------|--------|------|-------------|-------|--------------------------|---|---|
| Dimensions are in Inches | | | | | Part No. | | <h1>NTE Electronics</h1> | | |
| Unless Otherwise Specified | | | | | Approved | | | Title SMA Male to TNC Female Adaptor | |
| Tolerances | | | | | Date | | | | |
| 0.5-6 = ±0.2 6-30 = ±0.4 30-120 = ±0.6 120-315 = ±1 315-1000 = ±1.6 1000-2000 = ±2.4 | | | | | 11-22-2010 | | | | |
| | | | | | Checked | | Drawing No. 06-S011 | | |
| | | | | | Date | | | | |
| | | | | | 11-22-2010 | | File No. | | |
| | | | | | Drawn | | | | |
| | | | | | Date | | | | |
| | | | | | 11-22-2010 | | | | |
| No. | Description | Material | Finish | Q'ty | Drawing No. | Scale | 5/1 | Issue | A |

1 2 3 4 5 6 7 8