

Fixed Shroud Plug, 4mm

Features

- Accepts Cable up to .177" (4.5mm) Dia.
- Standard Colors: Black, Red



NTE Type No.	Color	Diag No.
72-031	Black	TL-021
72-032	Red	TL-021

TL-021

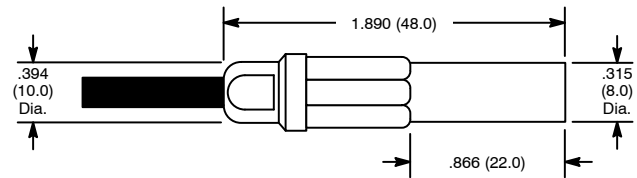

Specifications

IEC 1010 Rating: 1000V CAT3 20 Amps

Shutter Plug, 4mm

Features

- Accepts Cable up to .177" (4.5mm) Dia.
- Standard Colors: Black, Red



NTE Type No.	Color	Diag No.
72-033	Black	TL-022
72-034	Red	TL-022

TL-022

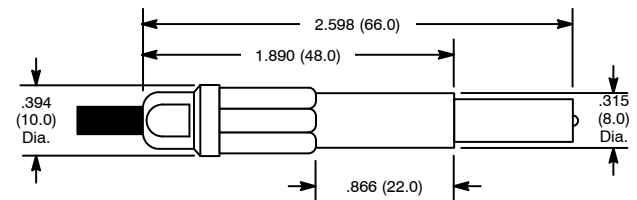

Specifications

IEC 1010 Rating: 1000V CAT3 20 Amps

Stackable Plug, 4mm

Features

- Accepts Cable up to .177" (4.5mm) Dia.
- Standard Colors: Black, Red



NTE Type No.	Color	Diag No.
72-061	Black	TL-023
72-062	Red	TL-023

TL-023

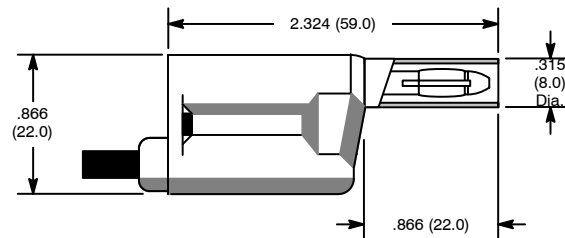

Specifications

IEC 1010 Rating: 1000V CAT3 20 Amps

Right Angle Plug, 4mm

Features

- Accepts Cable up to .177" (4.5mm) Dia.
- Standard Colors: Black, Red



NTE Type No.	Color	Diag No.
72-063	Black	TL-024
72-064	Red	TL-024

TL-024

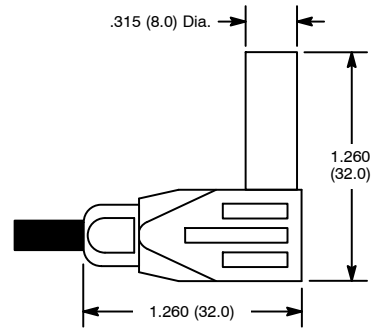

Specifications

IEC 1010 Rating: 1000V CAT3 □ 20 Amps

In Line Socket, 4mm

Features

- Accepts Cable up to .177" (4.5mm) Dia.
- Standard Colors: Black, Red



NTE Type No.	Color	Diag No.
72-035	Black	TL-025
72-036	Red	TL-025

TL-025

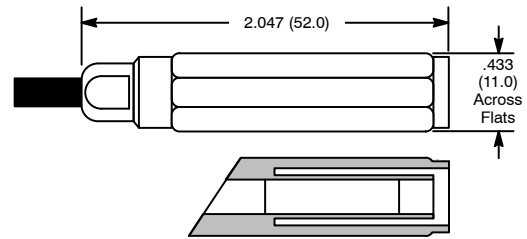

Specifications

IEC 1010 Rating: 1000V CAT3 □ 20 Amps

Cable Mountable Shrouded Banana Plug, 4mm

Features

- Nickel-Plated Brass Banana Plug with Nylon Insulator
- Allows For Quick and Easy Termination to Insulated Wire
- Standard Colors: Black, Red



NTE Type No.	Color	Diag No.
72-179-0	Black	TL-029
72-179-2	Red	TL-029

TL-029

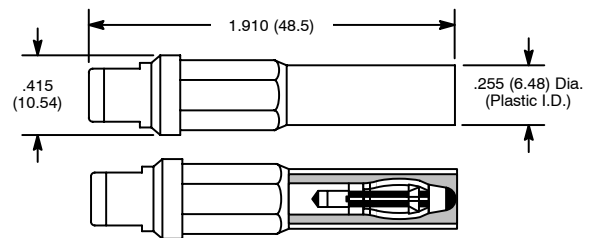

Specifications

IEC 1010 Rating: 1000V CAT3, 1500V CAT2, 20 Amps

NEW
NEW

Insulated Banana Coupler, 4mm

Features

- Nickel-Plated Brass Banana Plug with Nylon Insulator
- Mates with All Shrouded, Unshrouded and Retractable 4mm Banana Plugs
- Standard Colors: Black, Red



TL-030

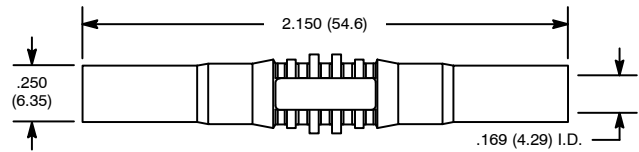

Specifications

IEC 1010 Rating: 1000V, 15 Amps

	NTE Type No.	Color	Diag No.
NEW	72-182-0	Black	TL-030
NEW	72-182-2	Red	TL-030