

# Power Jacks

## Features

- Panel Mount Types
- Metal Housing

## Specifications

**Rating:** 30VDC, 5A (57-PJ10 thru 57-PJ40)  
 24VDC, 2A (57-PJ50 thru 57-PJ80)  
 30VDC, 2A (57-PJ90 Only)

**Contact Resistance:**  $\leq 0.03\Omega$

**Insulation Resistance:**  $\geq 100M\Omega$

**Withstanding Voltage:** 500VAC

**Inserting and Extraction Force:** 3 to 20N

**Life Test:** 5000 cycles

**Temperature:**  $-20^{\circ}$  to  $+85^{\circ}\text{C}$

## Ordering Information

NTE Type No.	Description	Mounting Hole	Diag No.
57-PJ10	5.5mm x 2.1mm Jack	.437" (11.0)	JK-01
57-PJ20	5.5mm x 2.5mm Jack	.437" (11.0)	JK-01
57-PJ30	5.5mm x 2.1mm Jack	.313" (8.0)	JK-02
57-PJ40	5.5mm x 2.5mm Jack	.313" (8.0)	JK-02
<i>NEW</i> 57-PJ50	5.5mm x 2.1mm Jack	.320" (8.1)	JK-03
<i>NEW</i> 57-PJ60	5.5mm x 2.5mm Jack	.320" (8.1)	JK-03
<i>NEW</i> 57-PJ70	5.5mm x 2.1mm Jack	.320" (8.1)	JK-04
<i>NEW</i> 57-PJ80	5.5mm x 2.5mm Jack	.320" (8.1)	JK-04
<i>NEW</i> 57-PJ90	5.0mm x 2.1mm Jack	.350" (8.9) x .430" (10.9)	JK-05

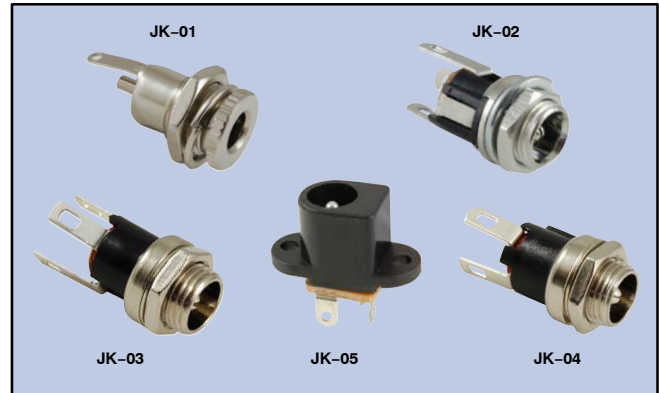

### JK-01

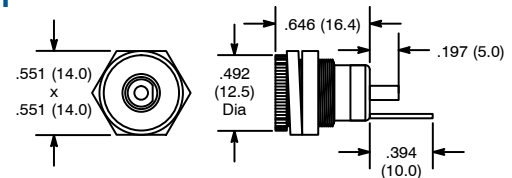

### JK-02

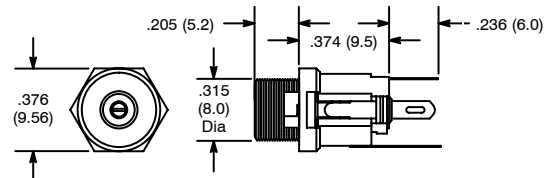

### JK-03

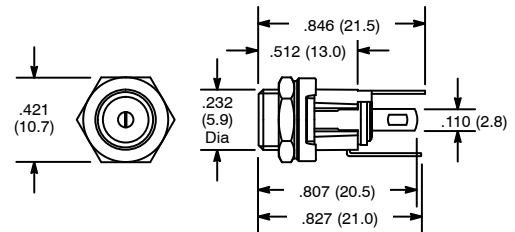

### JK-04

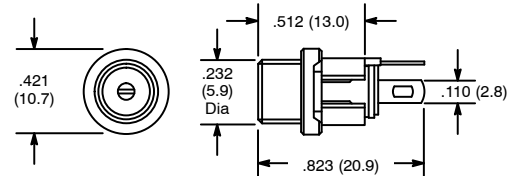

### JK-05

