

# 54-915

## Hardware, Removable Hole Plug

### Features:

- For Automotive/Marine Types
- With Non-Serrated Wings

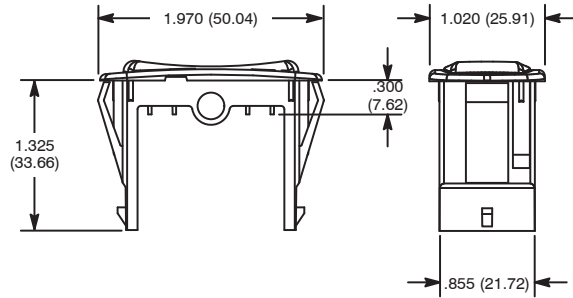

# 54-920, 54-921, 54-922, 54-923

## Hardware, Safety Cover

### Features:

- For Toggle Switch w/12mm (15/32") Mounting Hole
- Accepts Standard 17.5mm (11/16") Switch Handles
- Available in 4 Colors:
  - 54-920 (Red)
  - 54-921 (Red Metallic)
  - 54-922 (Blue Metallic)
  - 54-923 (Silver Metallic)

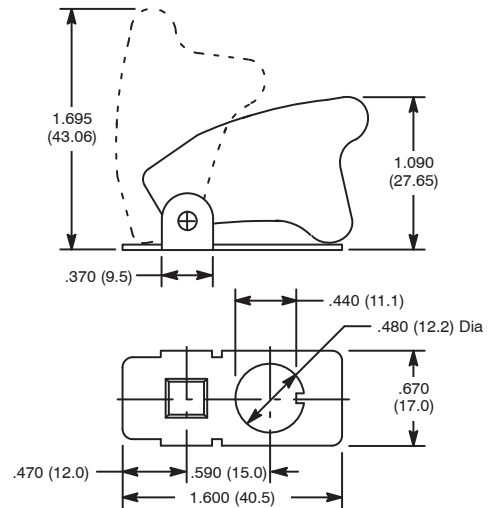

# 54-925

## Hardware, Indicator Plate

### Features:

- Nickel-Plated Steel
- Fits 15/32" [.466 (11.91mm)] Bushing
- For use with 54-727 Switch

