

Crocodile Clip, Flanged, Fully Insulated

Features

- UL/CSA Compliant
- Accepts All Standard 4mm Test Lead Plugs
- Offset Jaw & Special Tooth Design Grips Small and Large Diameter Test Points Securely



TL-010

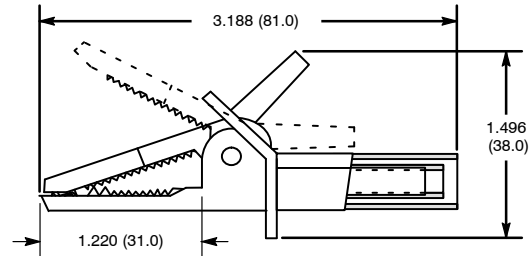

NTE Type No.	Color	Diag No.
72-053	Black	TL-010
72-054	Red	TL-010
72-054-KIT	Contains 1 ea. of 72-053 & 72-054	

Specifications

IEC 1010 Rating: 1000V CAT2 / 600V CAT3 20 Amps
 Maximum Jaw Opening: .945" (24mm)

NEW

Crocodile Clip, Small, Fully Insulated

Features

- Accepts All Standard 4mm Test Lead Plugs
- Small Size is Ideal for Connecting to Confined Test Points



TL-011

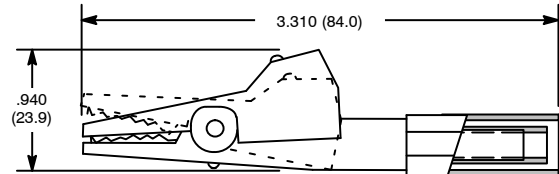

NTE Type No.	Color	Diag No.
72-055	Black	TL-011
72-056	Red	TL-011
72-056-KIT	Contains 1 ea. of 72-055 & 72-056	

Specifications

Rating: 1000V CAT2, 20 Amps
 Maximum Jaw Opening: .275" (7mm)

NEW

Crocodile Clip, Large, Fully Insulated

Features

- UL/CSA Compliant
- Accepts All Standard 4mm Test Lead Plugs
- Wide Jaw Opening & Special Tooth Design Assures Firm Grip and Electrical Contact



TL-012

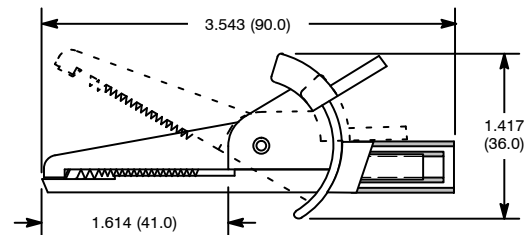

NTE Type No.	Color	Diag No.
72-057	Black	TL-012
72-058	Red	TL-012
72-058-KIT	Contains 1 ea. of 72-057 & 72-058	

Specifications

IEC 1010 Rating: 1000V CAT3 / 600V CAT4 30 Amps
 Maximum Jaw Opening: .866" (22mm)

NEW

Crocodile Clip, Screw Type

Features

- CE Compliant
- Compliant with EN61010-031 / A1:2008
- For Use With 1000V Fused Probe Bodies



TL-013

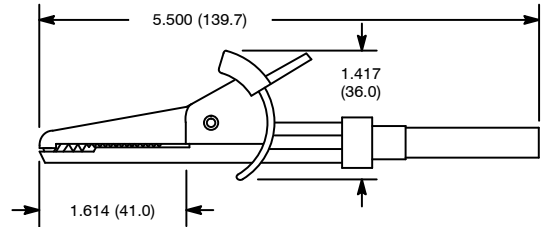

NTE Type No.	Color	Diag No.
72-059	Black	TL-013
72-060	Red	TL-013
72-060-KIT	Contains 1 ea. of 72-059 & 72-060	

Specifications

IEC 1010 Rating: 1000V CAT3

Rated Current: 10A

Maximum Jaw Opening: .866" (22mm)